

Weltevree Elementstair

Designer
Ontwerper
Floris Schoonderbeek

- 1 - Endless element
- 2 - Step up element
- 3 - Step off element
- 4 - Floor element
- 5 - Construction element
(by set of 2)

Material
Materiaal
Glass Fibre Polyester

Dimensions (endless element)
Afmetingen (eindeloos element)
75 x 80 x 95 cm

Colors
Kleuren
Any RAL colour

Weight
Gewicht
20 kg (each element)

Additional
Overig
Modulair system, flexibel
possibilities and heights

Delivery
Levertijd
4 - 8 weeks (excl. delivery costs)

Placement
Plaatsen
In consultation

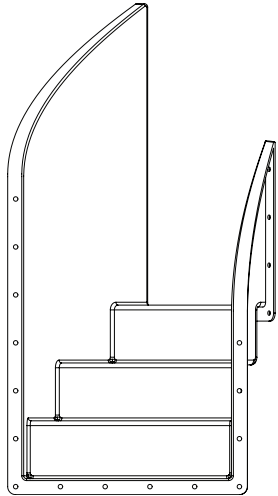

1 - Endless element

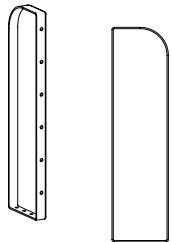

5 - Construction element (set)

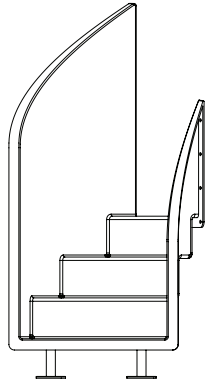

2 - Step up element (front view)

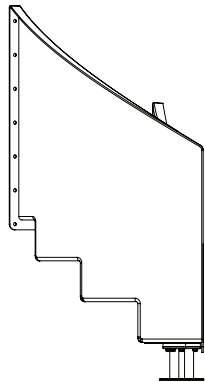

2 - Step up element (side view)

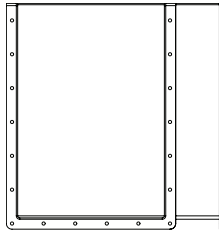

3 - Step off element (front view)

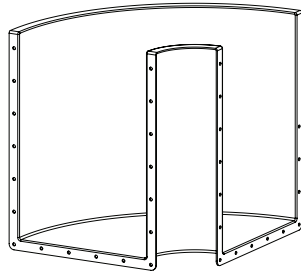

3 - Step off (side view)

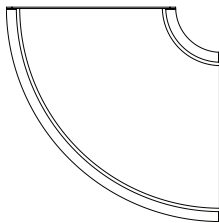

3 - Step off (top view)

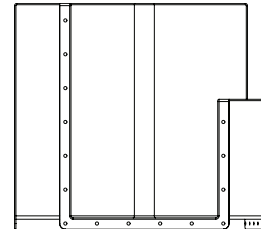

4 - Floor element (front view)

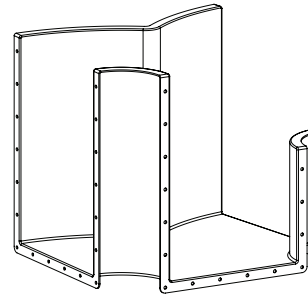

4 - Floor element (side view)

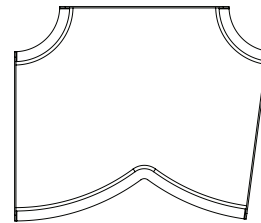

4 - Floor element (top view)

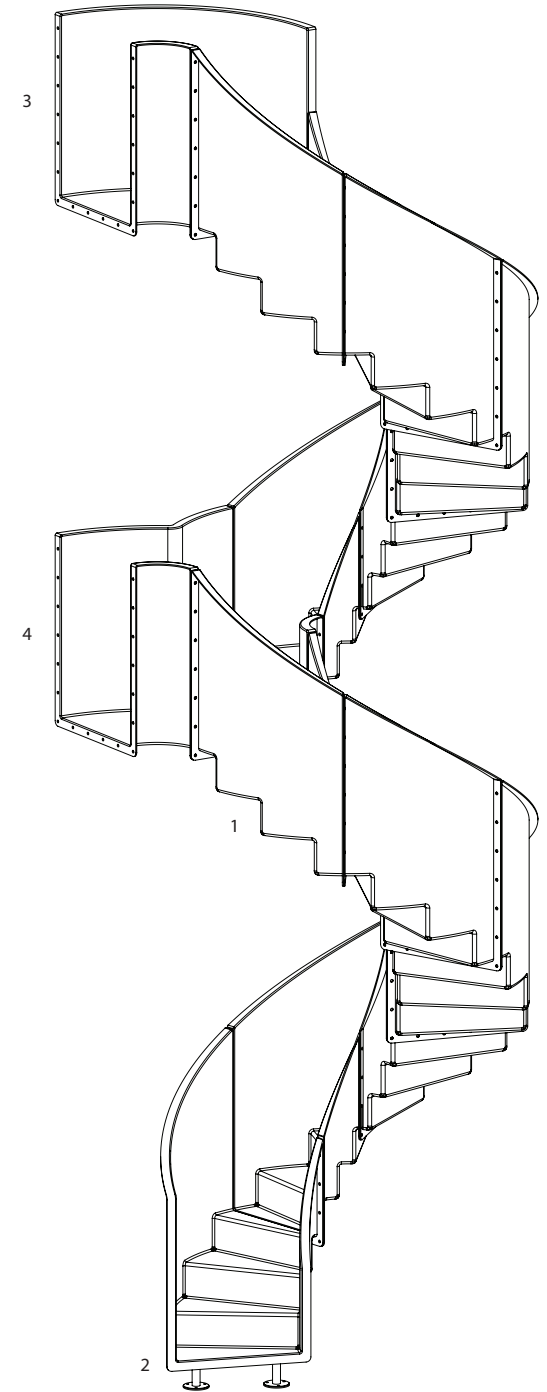

Constructed Elementstair (3 floor example)